



(Photo: Joan Wheeler)

The National Trust of Australia (NSW)

National Trust Venue Hire | **Everglades House & Garden** Leura, Blue Mountains

DESCRIPTION

Constructed in the 1930s by Danish-born landscape gardener Paul Sorensen in conjunction with owner Henri Van De Velde, Everglades gardens is Australia's most spectacular inter-war period garden and has received acclaim from garden lovers worldwide.

Everglades Gardens is a sought-after location for weddings, so brides need to book early to reserve their time in this beautiful setting. The 1930s classical English style gardens set in the stunning World Heritage listed Blue Mountains are ideal for those who want something more natural: consider getting married in the shady glens or terraces of the gardens. The gardens are lovely in spring when the cherry blossoms and daffodils are in bloom and equally attractive in autumn with the trees aflame in orange, yellows and reds.

Wedding photos can be taken throughout the garden. Everglades can also provide buffet catering for your event. If the weather turns, events can be held in the art gallery in Everglades' grounds, or in the 1930s Art Deco style Everglades House.



(Photos- Top and middle: Christopher Shain. Bottom: Susan Rae Muldrock)

National Trust Venue Hire | Everglades House & Gardens

Venue Option	Capacity	Fee*	Inclusions	Extra Info
Gardens – wedding ceremony & photography or other function	70	\$800 up to 60 guests, \$8 for each person above 60 guests. (No charge for bridal couple or children under 3 years.)	Up to two hours for ceremony, toast & photography. You choose a site in the gardens for the ceremony. Wedding photographs can be taken throughout the gardens.	Weddings during daylight hours only. Site remains open to the public. No rice, confetti or red carpet, but rose petals and bubbles are permitted.
Gardens – Wedding Photography only	Up to 10 (Bridal Party)	\$350 location fee, \$8 per head for additional members .	Up to two hours access to the 8 acres of formal gardens.	Photographer hire not included. Site remains open to the public.

*25% discount Mon-Thurs. National Trust members also receive 10% discount Fri – Sun.

SITE PLAN

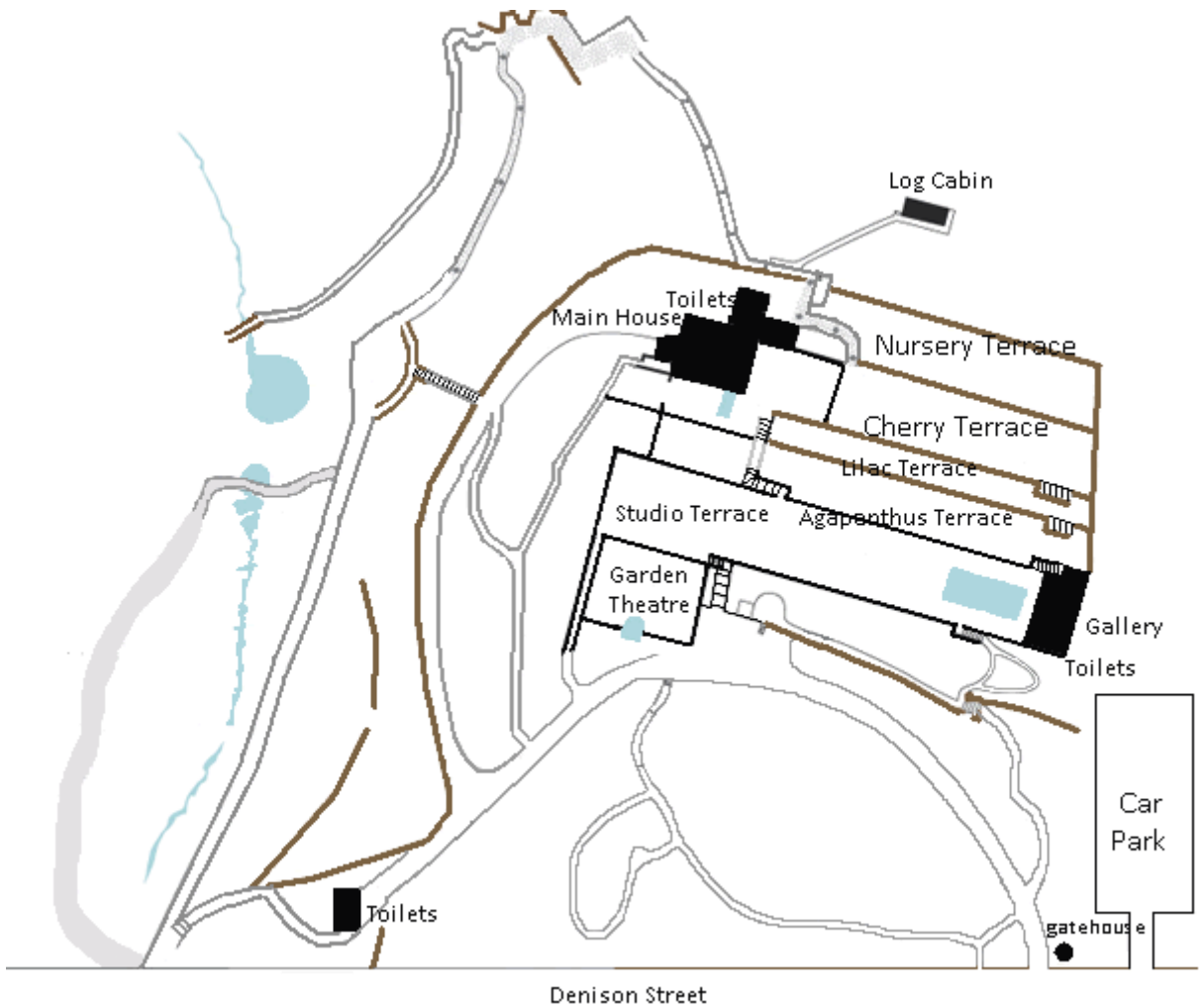

CATERING & EQUIPMENT HIRE

Drinks & nibbles for the toast and photographic session are permitted, for which you may arrange your own catering, or hire Everglades catering service. See table below for details of equipment for hire:

Item for Hire	Price
Chairs	\$2 each
Trestle table	\$10
Trestle table with cloth	\$15
Cup/Saucer	\$0.50
Ground repair (if marquee is hired)	\$50

BOOKING & PAYMENT

If you are interested in booking Everglades House & Gardens for your event, please fill out a Booking Enquiry Form. To confirm a booking, Everglades requires a non-refundable deposit of \$375. Final payment is sent a week before the wedding along with a guest list. For photography only bookings, no deposit is required.

MAP & DIRECTIONS

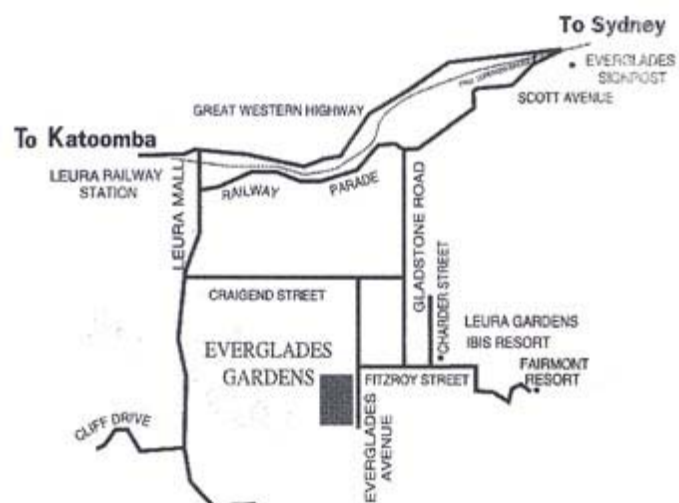

You can also walk to Everglades from Leura Station in 20 minutes. From the station, go east down Railway Parade, take the fourth right into Victoria Street, cross Megalong St and continue to Craigend St where you dog-leg left then right into Everglades Ave. Everglades is down the far end.

CONTACT INFORMATION

Address: 37, Everglades Avenue, Leura, Blue Mountains
Phone: (02) 4784 1938
Email: evergladesgardens@bigpond.com
Website: www.everglades.org.au
 www.nationaltrust.com.au

