



*(Photo: Christopher Shain)*

The National Trust of Australia (NSW)

## National Trust Venue Hire | **Grossmann & Brough House** Maitland

### DESCRIPTION

Grossmann House and Brough House are two mirror image Victorian Regency properties, built side by side on the same lot in 1871.

In recent years, the National Trust has restored Grossmann house to reflect the status and era of its Victorian owners. Gas lighting has been re-installed, and wallpapers recreated from surviving fragments. Characteristic furnishings complete the experience.

The attractive gardens at the twin properties are ideal for boutique outside weddings and/or wedding photographs. Shots of the wedding party inside the 1870 Grossmann House can also be accommodated.

Brough House can be hired for a small wedding reception, as a conference centre, as a small concert hall or for an art exhibition. The Cecily Mitchell room acoustics are exceptional. If you like the idea of a traditional Victorian home with its quaint features as the backdrop to your event, this venue is ideal.



*(Top and middle photos:*

## National Trust Venue Hire | Grossman & Brough Houses

Venue Option	Capacity	Fee*	Inclusions
<b>Gardens – wedding ceremony &amp; reception</b>	Up to 80 people using property chairs, more (100+) if extra chairs are needed.	\$120	Use of the gardens for wedding ceremony and reception, 80 chairs can be provided.
<b>Photography in Grossman House</b>	Wedding party only.	\$30	Use of Grossman House for wedding or other photography, in conjunction with use of the garden. Photographer not included.
<b>Brough House – wedding reception</b>	35	\$50/ hour plus \$10/ head	Use of Brough House for a wedding reception.
<b>Cecily Mitchell Room</b>	Conference- 50 Concert – 60 Exhibition - 100	\$25/hour	Use of the Cecily Mitchell Room.

\*National Trust Members receive 10% off fee

### SITE PLAN

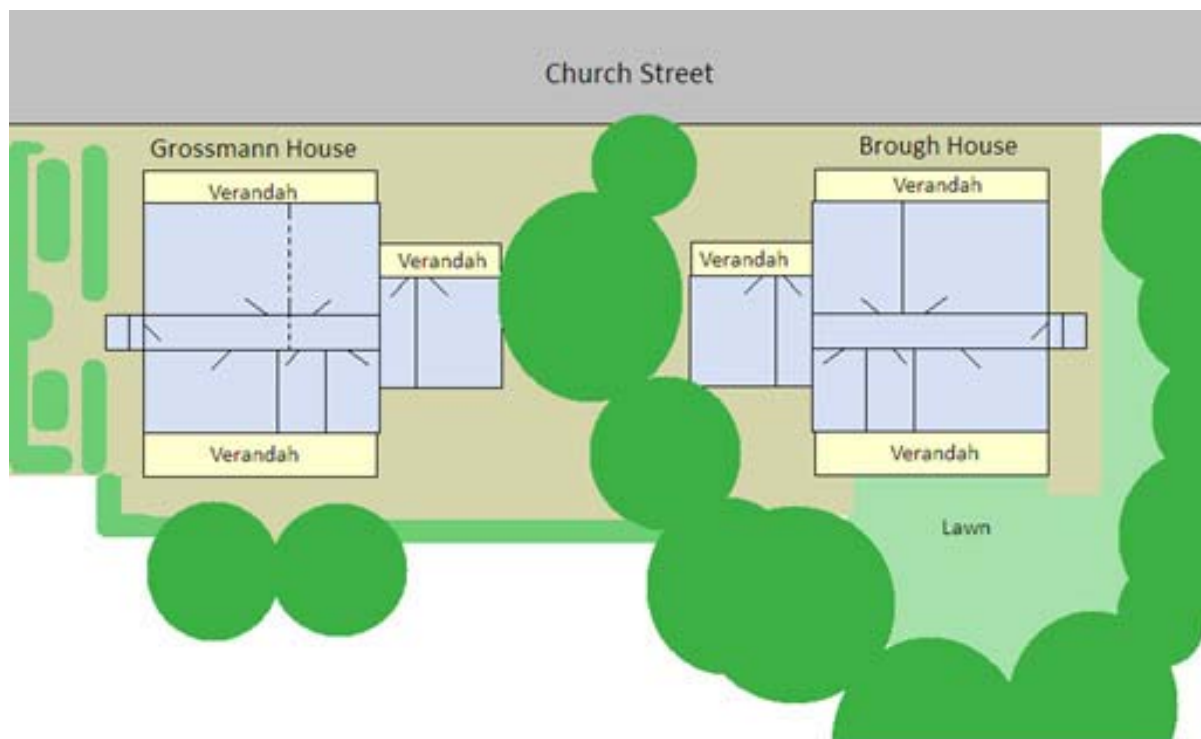

(Please note: this drawing is not to scale, and is to be used as a rough guide only)



## CATERING & EQUIPMENT HIRE

Catering can be arranged by the property if required, or alternatively outside caterers are permitted. Chairs are available for hire in the garden for \$0.30 each.

The hirer is permitted to provide music equipment etc.

Disabled access is available on the ground floor of both houses and to toilet facilities (separate building).

## BOOKING & PAYMENT

If you would like to book Grossmann and Brough House for your event then please fill out a booking enquiry form and return it to the property. A deposit must be paid upon confirmation of booking, and the full balance must be paid at least one week before the function.

## CONTACT DETAILS

**Address:** Church Street, Maitland  
**Postal:** PO Box 110 NSW 2320  
**Phone:** (02) 4933 6542  
**Email:** grossmannhouse@nationaltrust.com.au  
**Web:** www.nationaltrust.com.au

